

Installation Quick Reference  
**Push-to-Talk V2 Ceiling Speaker**

**011180**, RAL 9002, Gray White, Standard  
**011181**, RAL 9003, Signal White, Optional



Parameter	Factory Default Setting
IP Addressing	DHCP
IP Address <sup>a</sup>	10.10.10.10
Web Access Username	admin
Web Access Password	admin
Subnet Mask <sup>a</sup>	255.0.0.0
Default Gateway <sup>a</sup>	10.0.0.1

a. Default if there is not a DHCP server present.

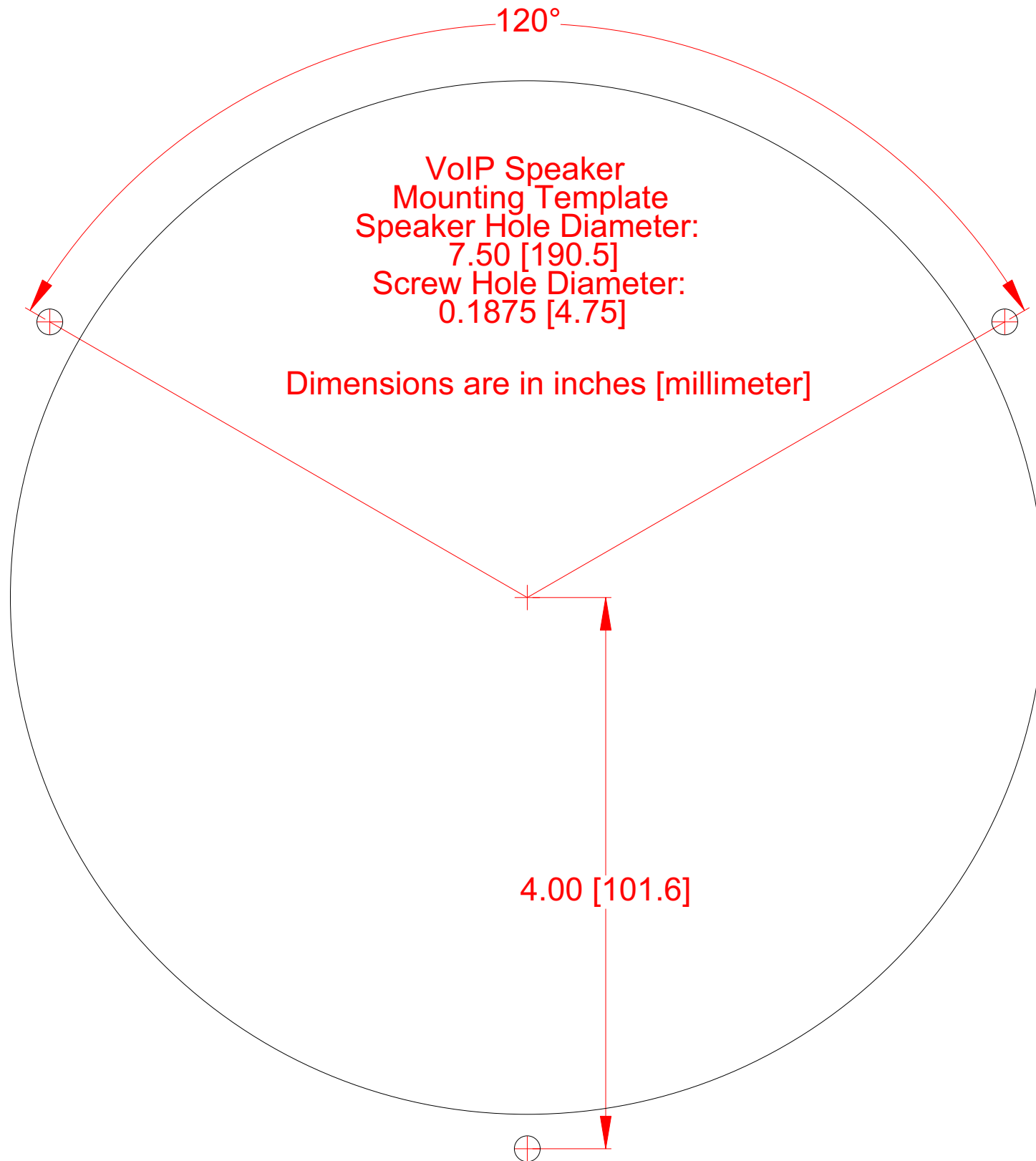

Typical System Installation

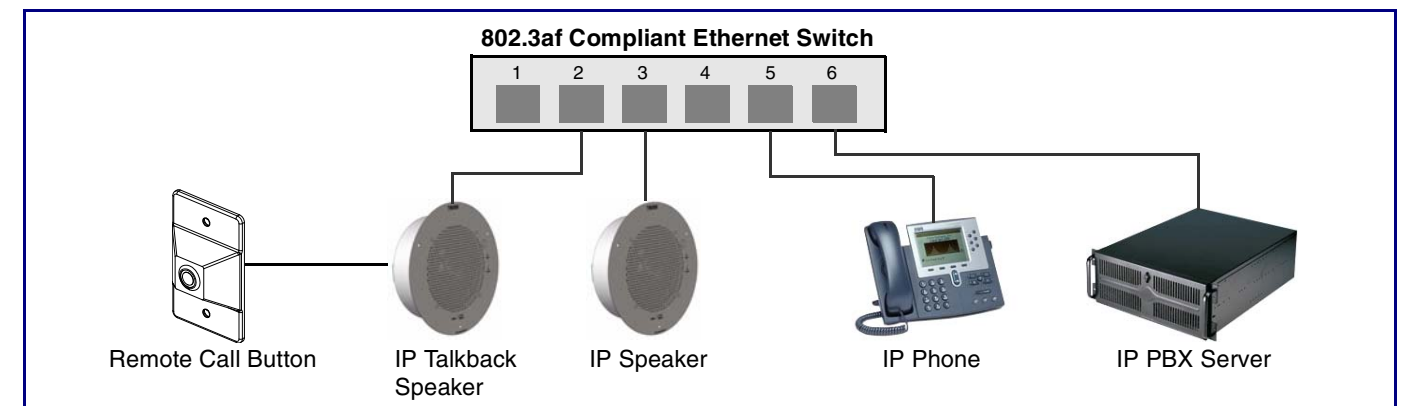

Getting Started

- Download the *Push-to-Talk V2 Ceiling Speaker Operations Guide* PDF file from the **Documentation** page at: <http://www.cyberdata.net/products/voip/digitalanalog/ceilingspkr2ptt/docs.html>
- Create a plan for the locations of your speakers.
- Prior to installation, consult local building and electrical code requirements.

Parts

<p><b>(1) Speaker Assembly</b></p> <p><b>(1) Template for Speaker and Screw Holes*</b></p> <p><i>* See the last page of this document</i></p>	<p><b>(1) Drop Ceiling Mounting Kit</b></p> <p>(3) #8 Nylon Thumb Nuts</p> <p>(3) #8 Fender Washers</p> <p>(3) 8-32 x 1 1/4" Mounting Screws</p>	<p><b>(1) Drywall Mounting Kit</b></p> <p>(3) Plastic Ribbed Anchors</p> <p>(3) #8 Sheet Metal Screws</p>	<p><b>(1) Call Button Assembly</b></p> <p><b>(1) Wall Mounting Kit</b></p> <p>(2) Mounting screws</p>
---	--	---	---

## Dimensions and Connections

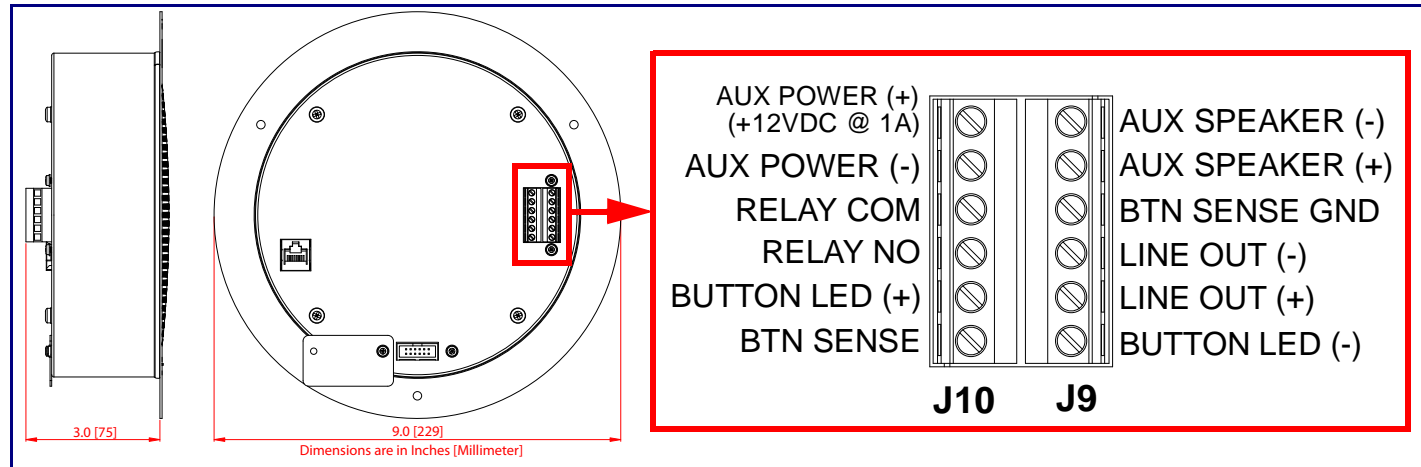

## Connecting Power

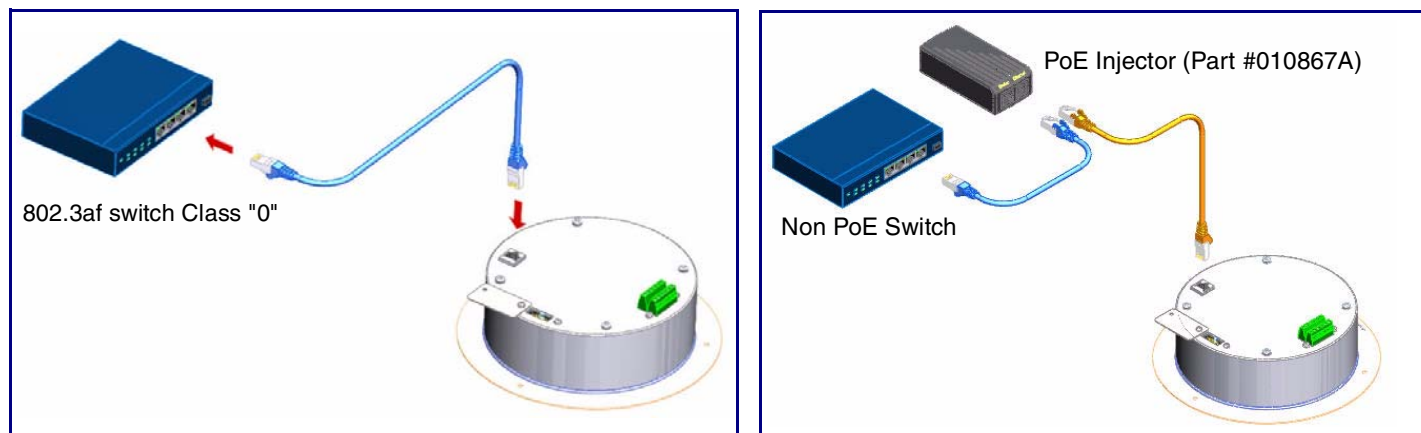

## Features

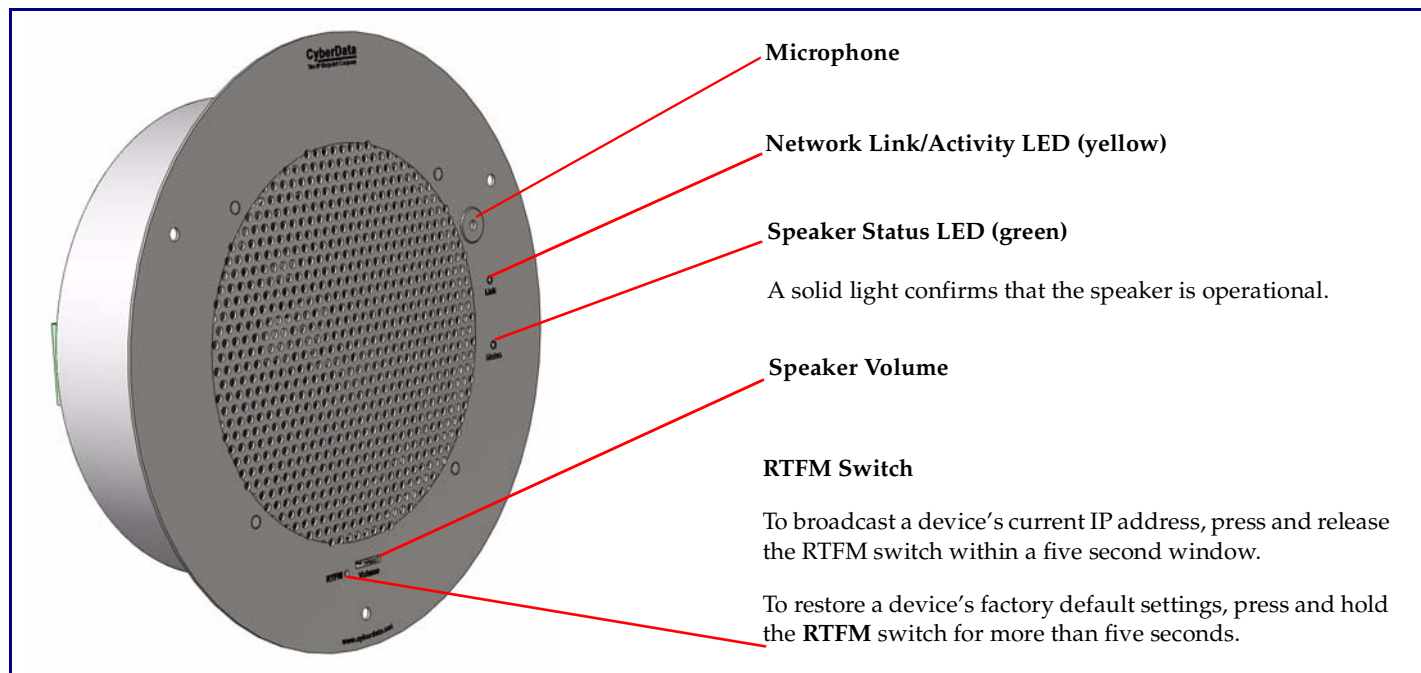

## Mounting

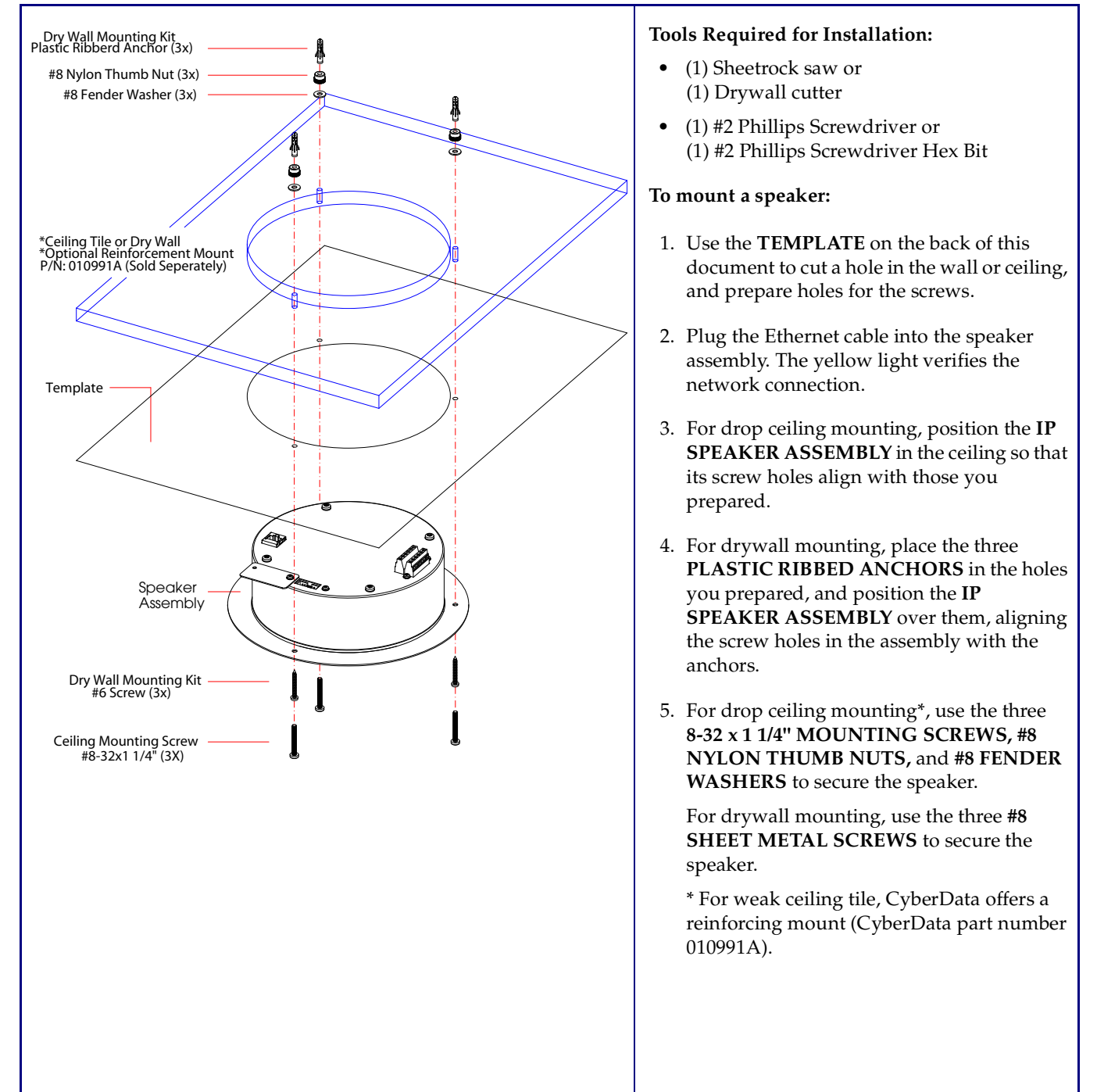

## Contacting CyberData

### Corporate Headquarters

CyberData Corporation  
3 Justin Court  
Monterey, CA 93940, USA

Phone: 831-373-2601  
Fax: 831-373-4193  
www.CyberData.net

Sales: (831) 373-2601 ext. 334  
Support: 831-373-2601 ext. 333  
Web: <http://www.cyberdata.net/support/contactsupportvoip.html>  
RMA Dept: (831) 373-2601 ext. 136  
Email: [RMA@CyberData.net](mailto:RMA@CyberData.net)  
RMA Status: <http://www.cyberdata.net/support/rmastatus.html>

Warranty information is available at:  
Web: <http://www.cyberdata.net/support/warranty/index.html>

## Mounting Options—Metal Bracket

To be installed and or used in accordance with the appropriate electrical codes and regulations.

**Wall Plate Mounting Bracket (Metal)**  
**Tools Required:** Wall board saw, Pliers  
**Instructions:**

1. Use the inside area of the bracket to trace the hole cut onto the wall.
2. Using a wall board saw or matt knife, cut along the stencil line.
3. Place bracket against the wall opening.
4. Bend tabs up and down against the inside wall to secure the bracket.
5. Place the optional gasket over the metal bracket.
6. Mount the flush mount wall plate to the bracket.

## Mounting Options—Plastic Bracket

To be installed and or used in accordance with the appropriate electrical codes and regulations.

**Wall Plate Mounting Bracket (Plastic)**  
**Tools Required:** Wall board saw, Philips screwdriver  
**Instructions:**

1. Use the inside area of the bracket to trace the hole cut onto the wall.
2. Using a wall board saw or matt knife, cut along the stencil line.
3. Place bracket through the wall opening.
4. Tighten screws to pull Flagnuts against the inside wall to secure the bracket.
5. Place the optional gasket over the plastic bracket.
6. Mount the flush mount wall plate to the bracket.

## Contacting CyberData

### Corporate Headquarters

CyberData Corporation  
 3 Justin Court  
 Monterey, CA 93940, USA

Phone: 831-373-2601  
 Fax: 831-373-4193  
 www.CyberData.net

Sales: (831) 373-2601 ext. 334  
 Support: 831-373-2601 ext. 333  
 Web: <http://www.cyberdata.net/support/contactsupportvoip.html>  
 RMA Dept: (831) 373-2601 ext. 136  
 Email: [RMA@CyberData.net](mailto:RMA@CyberData.net)  
 RMA Status: <http://www.cyberdata.net/support/rmastatus.html>

Warranty information is available at:  
 Web: <http://www.cyberdata.net/support/warranty/index.html>



## Installation Quick Reference

# Push-to-Talk V2 Ceiling Speaker

**011184**, RAL 9002, Gray White, Standard  
**011185**, RAL 9003, Signal White, Optional

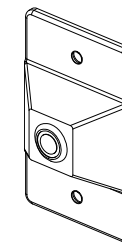

As an option to the CyberData V2 speaker, the V2 Remote Call Button enables calls to the V2 Speaker that can be initiated or answered from a remotely-mounted switch.

When enabled through the Web interface, if the Remote Call Button is pressed, the speaker would initiate a SIP call to a predetermined extension.

When the V2 Speaker is called from a remote phone and Auto-Answer is not enabled within the unit's Web interface, the LED on the Remote Button will blink. The call will be answered when the button is pressed.

## Typical Singlewire Speaker System Installation

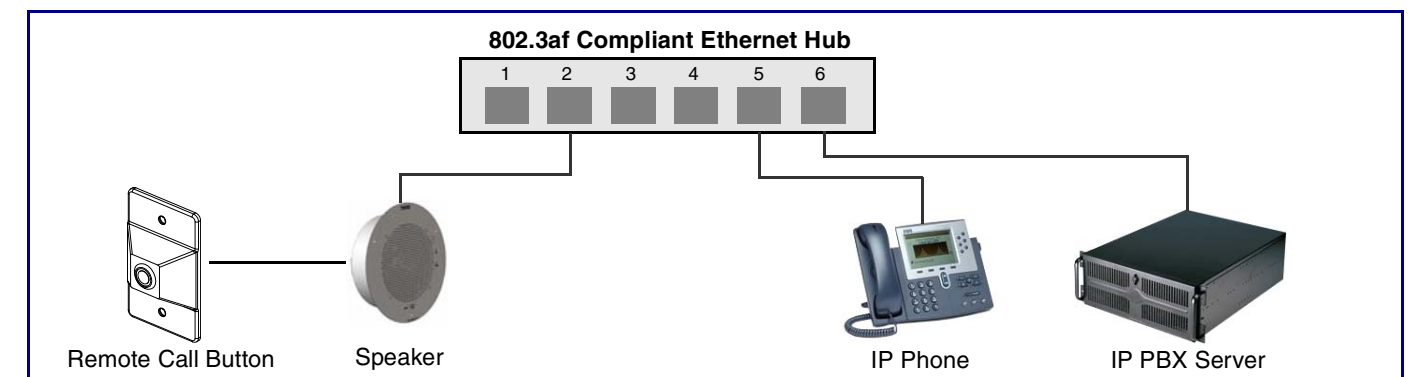

## Getting Started

- Create a plan for the locations of your Singlewire Speakers.
- Prior to installation, consult local building and electrical code requirements.
- **WARNING: This enclosure is not rated for any AC voltages!**

## Parts

<p><b>(1) Call Button Assembly</b></p> <p><b>(1) Wall Mounting Kit</b>                  (2) Mounting screws</p>	<p><b>Optional Parts (Not Included)</b></p> <p>(1) Optional Gasket</p> <p>(1) Optional One-Gang, Low Voltage, Mounting Bracket (Metal)</p>	<p>(1) Optional One-Gang Box (Metal)</p> <p>(1) Optional One-Gang, Low Voltage, Mounting Bracket (Plastic)</p>	<p>(1) Optional One-Gang Box (Plastic)</p>
---	--	--	--

## Connections

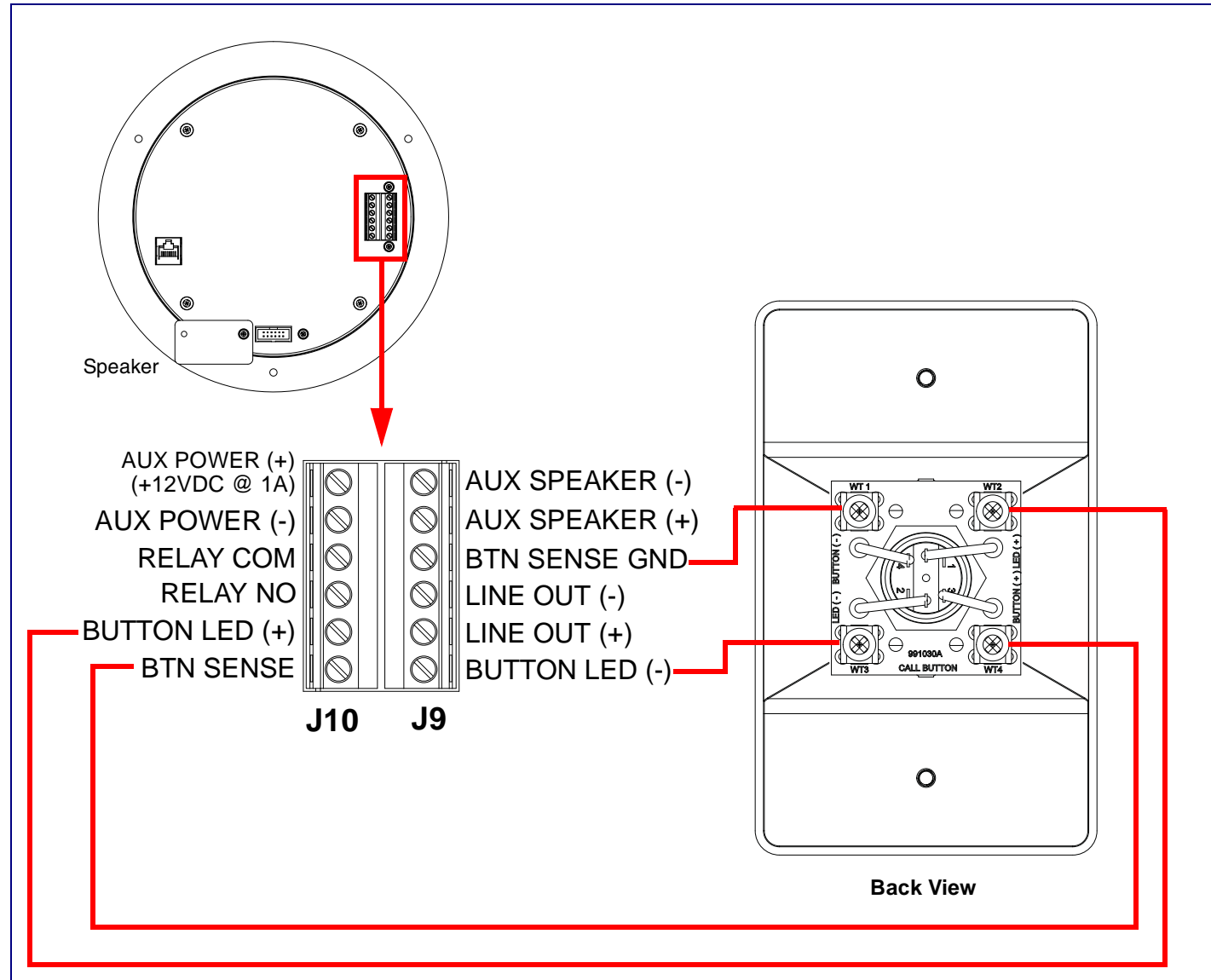

## Dimensions

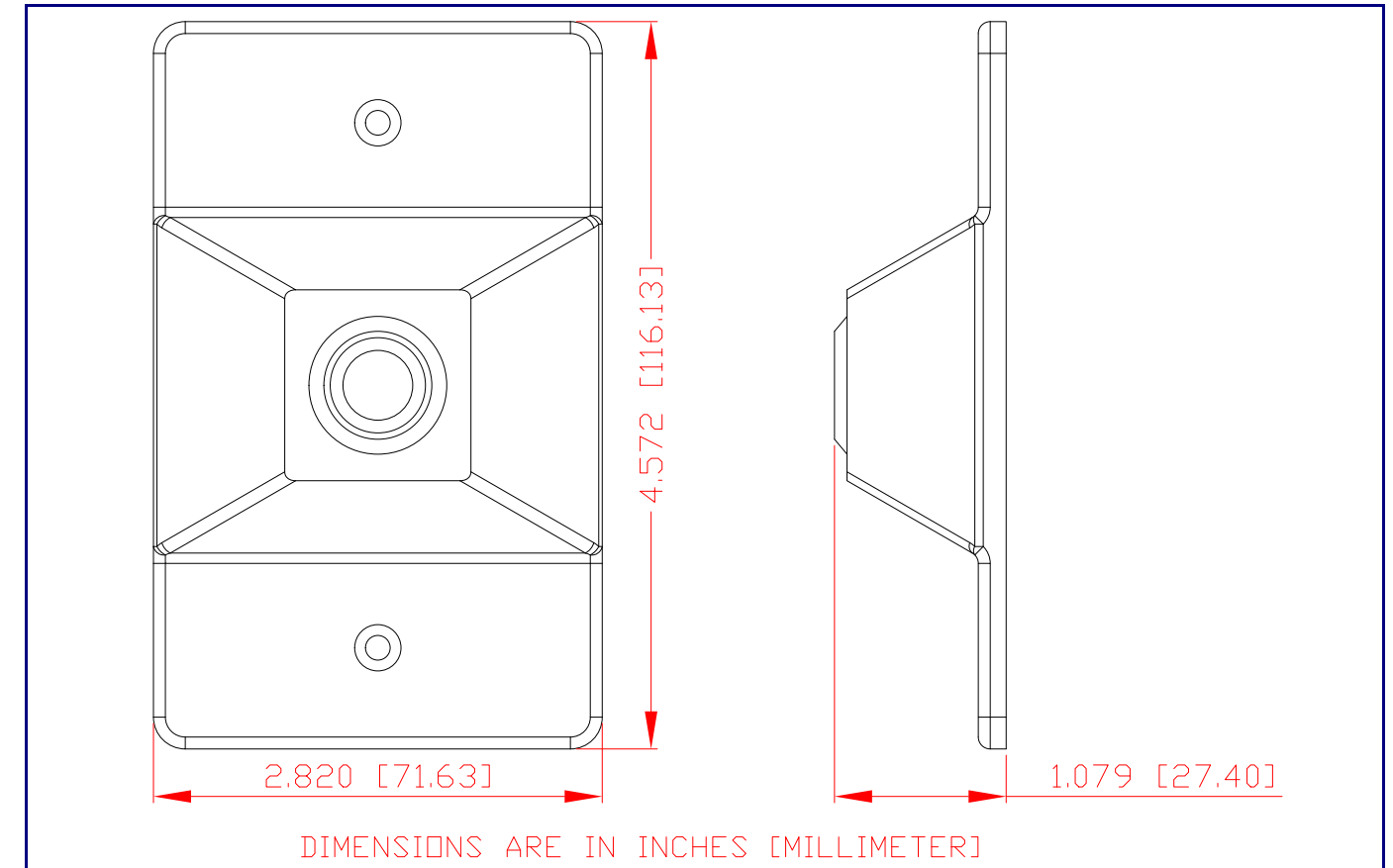

## Mounting Options—One-Gang Box (Metal or Plastic)

To be installed and or used in accordance with the appropriate electrical codes and regulations.

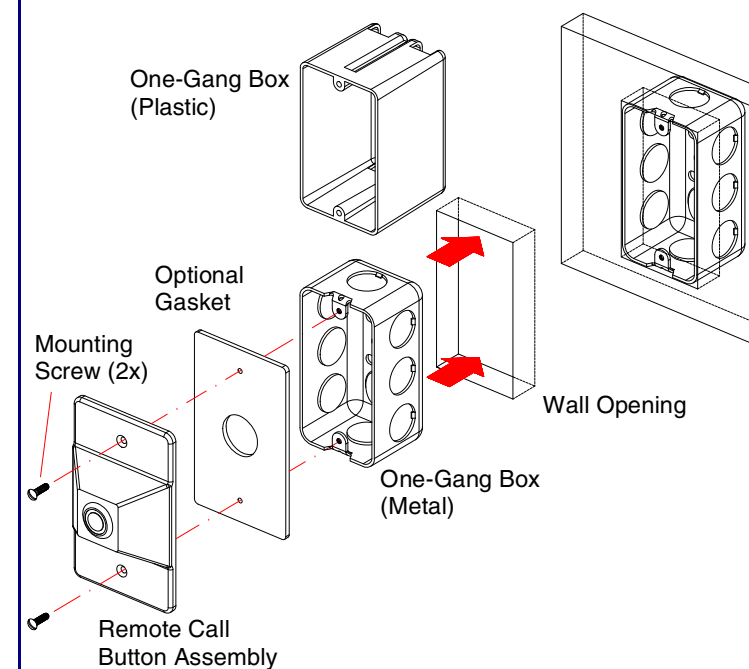

### Wall Plate Mounting Bracket One-Gang Box (Metal or Plastic)

**Tools Required:** Wall board saw

#### Instructions:

1. Use the outside area of the One-Gang Box to trace the hole cut onto the wall.
2. Using a wall board saw or matt knife, cut along the stencil line.
3. Place One-Gang Box through the wall opening.
4. **Optional:** Nail the One-Gang Box to the stud or connect it to the set screw connect and conduit.
5. Place the optional gasket over the One-Gang Box.
6. Mount the flush mount wall plate to the One-Gang Box.