

Calisto® 620

Bluetooth Wireless Speakerphone + Bluetooth USB Adapter

Designed in Santa Cruz, California

QUICK START GUIDE

plantronics

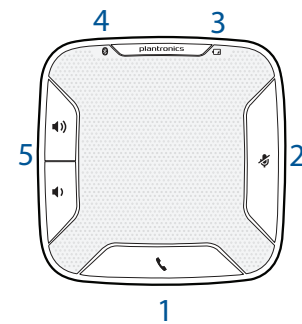

- 1 Call button**
Answer or end a call 1 tap
- 2 Mute microphone button**
Mute/Unmute mic 1 tap mutes; LED turns solid red/ 1 tap unmutes; LED turns off
- 3 Pairing**
Flashing red/blue In pairing mode
- 4 Power LED**
Indicates battery status See user guide at <http://docs.plantronics.com/calisto-620>
- 5 Volume up, Volume down**
Increase/decrease volume Press up/down volume buttons

1 Speakerphone Charge

Charge of a minimum of 30 minutes needed for complete setup.

The speakerphone can be charged with a wall charger or with a USB cord and your PC. The power LED on the speakerphone will be solid red when charging and off when fully charged.

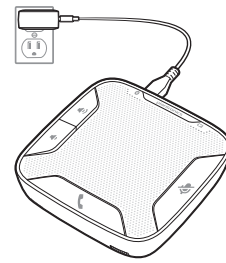

A full charge with a wall charger will take approximately 1 ½ hours.

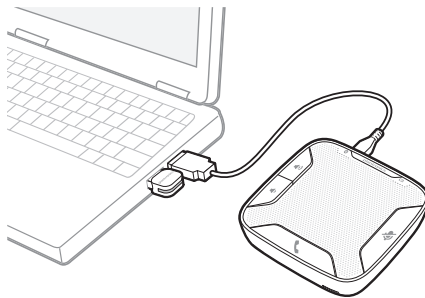

A full charge with a USB cord and your PC will take approximately 2 ½ hours.

NOTE To charge the speakerphone with the USB cable and PC, the PC must be on and in an active state (not standby). See the complete user guide at <http://docs.plantronics.com/calisto-620>

Turn speakerphone off when not in use to save battery power.

2 PC Connect and Call

- 1 Insert the Bluetooth® USB adapter into the PC.

NOTE For best results plug directly into PC and not a hub or docking station.

The speakerphone and USB adapter are pre-paired and will connect automatically when USB adapter is connected to the PC and the speakerphone is powered on and in range of the PC.

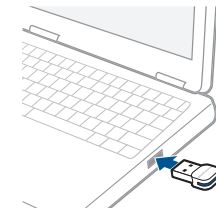

- 2 Slide the power switch on the speakerphone to the "On" position.

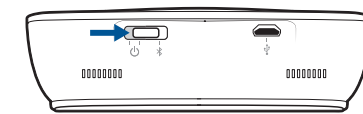

The LED on the USB adapter will flash and then turn solid blue when the speakerphone is connected to the Bluetooth adapter.

- 3 Load Plantronics Enterprise software by visiting plantronics.com/software and click on the download button.
- 4 Check your audio settings, as necessary. Confirm the speaker and microphone settings for your PC softphone are set to **Plantronics BT300C**.

Windows 7®

Go to Control Panel -> Sound-> Playback tab, and set the Plantronics BT300C device as both the Default Communications Device and the Default Audio Device. In the Playback tab, this is indicated by the green checkmark.

Windows XP®

Go to Control Panel -> Sounds and Audio Devices, and in the Audio tab set the Plantronics BT300C for both the Sound playback and Sound recording sections. In the Voice tab, select the Plantronics BT300C item for both the Voice playback and Voice recording sections.

- 5 Make a test call from your computer softphone. During an active call, the Bluetooth USB adapter will flash blue.
- 6 End the call by pressing the speakerphone call button.

3 Mobile Phone Connect and Call

- 1 Ensure your speakerphone is fully charged. Place the speakerphone in pairing mode by pressing and holding the power button to the RIGHT until the Bluetooth pairing LED flashes RED/BLUE.

NOTE If you don't see the red and blue flash, slide the power button all the way LEFT to turn speakerphone off. Then press and hold the power button again until you see the red and blue flash.

The speakerphone will stay in pairing mode for ten minutes.

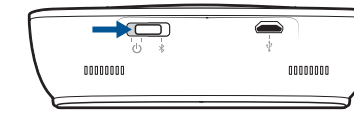

- 2 Place Bluetooth mobile phone into search mode. Select **Calisto 620** from the list of devices found.

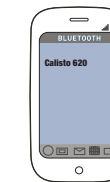

- 3 If prompted by your mobile phone for a passcode enter **0000**. The LED will stop flashing when your speakerphone and phone are successfully paired.
- 4 Make a test call from your mobile phone.
- 5 End the call by pressing the speakerphone call button.

Bluetooth Connection To Re-Pair USB adapter

In the event the USB adapter and speakerphone become unpaired.

- 1 Start with the speakerphone powered off.
- 2 Remove the Bluetooth USB adapter.
- 3 Place the speakerphone in pairing mode by pressing and holding the power button to the RIGHT until the Bluetooth pairing LED flashes BLUE/RED.
- 4 Insert the Bluetooth USB adapter into your PC USB port. The LED will flash and then turn solid blue to indicate the speakerphone is connected to the Bluetooth USB adapter.
- 5 Speakerphone will exit pairing mode. See the complete user guide at <http://docs.plantronics.com/calisto-620> The speakerphone wireless range is 10m/33feet

NEED MORE HELP?

Online user guide

<http://docs.plantronics.com/calisto-620>

Product support

<http://www.plantronics.com/support>

Please refer to the separate safety instructions for important product safety information prior to installation or use.

Declaration of Conformity

We Plantronics, 345 Encinal Street, Santa Cruz, California, 95060 USA (800) 544-4660, declare under our sole responsibility that the product BT300 Adapter complies with Part 15 of the FCC Rules. Operation is subject to the following two conditions: (1) this device may not cause harmful interference, and (2) this device must accept any interference received, including interference that may cause undesired operation.

Exposure to RF Radiation

The internal wireless radio operates within the guidelines found in radio frequency safety standards and recommendations, which reflect the consensus of the scientific community. Independent studies have shown that the internal wireless radio is safe for use by consumers. Visit plantronics.com for more information.

In order to comply with FCC and IC RF Exposure requirements, the base must be installed and operated such that a minimum separation distance of 20 cm is maintained between the base and all persons during normal operation.

NOTE: Modifications not expressly approved by Plantronics, Inc. could void the user's authority to operate the equipment.

Industry Canada Regulatory Information

This product meets the applicable Industry Canada technical specifications/Le présent matériel est conforme aux spécifications techniques applicables d'Industrie Canada. This Class B digital apparatus complies with Canadian ICES-003. /Cet appareil numérique de la classe

plantronics®
Simply Smarter Communications™

Plantronics, Inc.
345 Encinal Street
Santa Cruz, CA 95060
United States

©2012 Plantronics, Inc. All rights reserved. Plantronics and Calisto are trademarks or registered trademarks of Plantronics, Inc. The Bluetooth trademark is owned by Bluetooth SIG, Inc. and any use of the mark by Plantronics, Inc. is under license. Microsoft, Lync, Windows, and Windows XP are registered trademarks of Microsoft Corporation in the US and other countries.

Calisto 620 consists of a P620 wireless speakerphone and a BT300C Bluetooth USB adapter.